



**University of  
Zurich** UZH

**Main Library**



# **EndNote 20: Established and New Features**

**Coffee Lecture**

December, 01 2021



## Established Features

- PDF import
- Easy import of references from PubMed
- Automatic search for PDFs
- Insert citations in Word
- Easy reformatting to different output styles
- Consistent handling of journal titles



## PDF import

### Single PDF import

1. Choose pdf in your folder

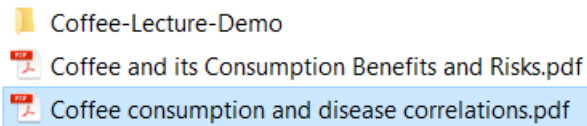

2. drag and drop it in this section

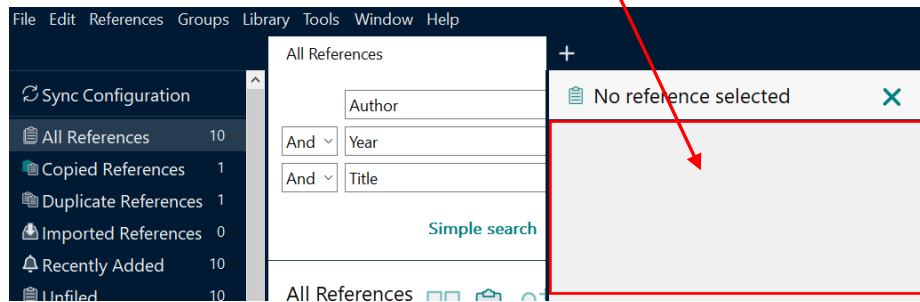

### PDF group import

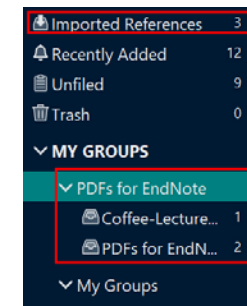
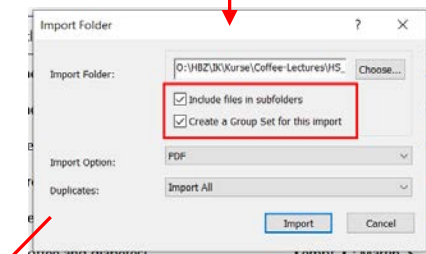
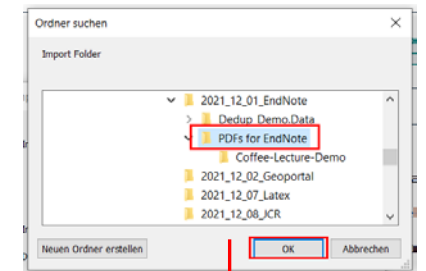
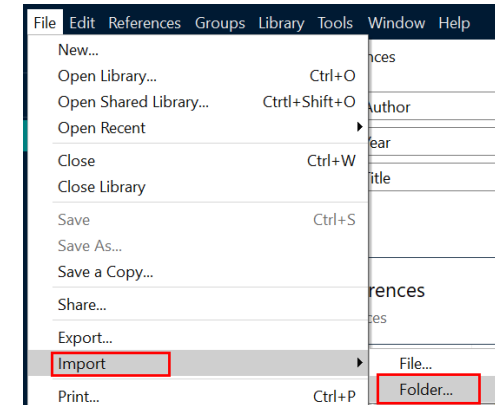

PDFs for EndNote			
3 References			
	Year	Title	Author
	2011	Coffee and its consumption: benefits an...	Butt, M. S.; Sultan, M. T.
	2019	Coffee consumption and disease correla...	Gokcen, B. B.; Sanlier, N.
	2017	The Impact of Coffee on Health	Nieber, K.



## PDF renaming

prior to PDF import

Choose any of these options:

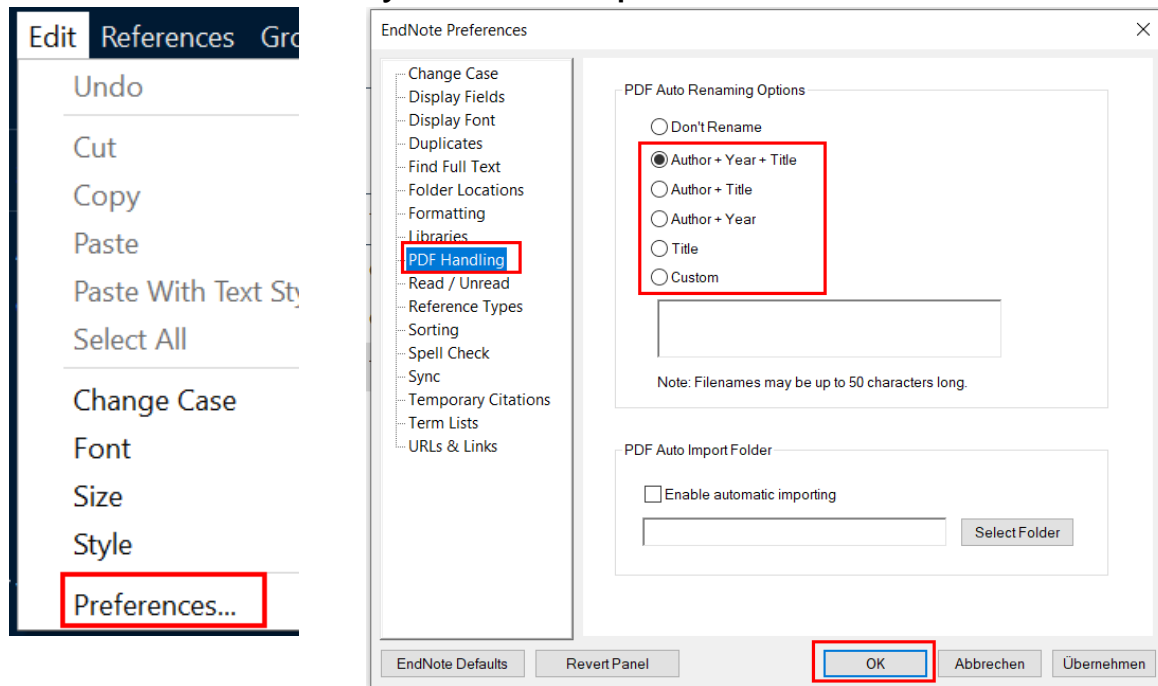

after PDF import

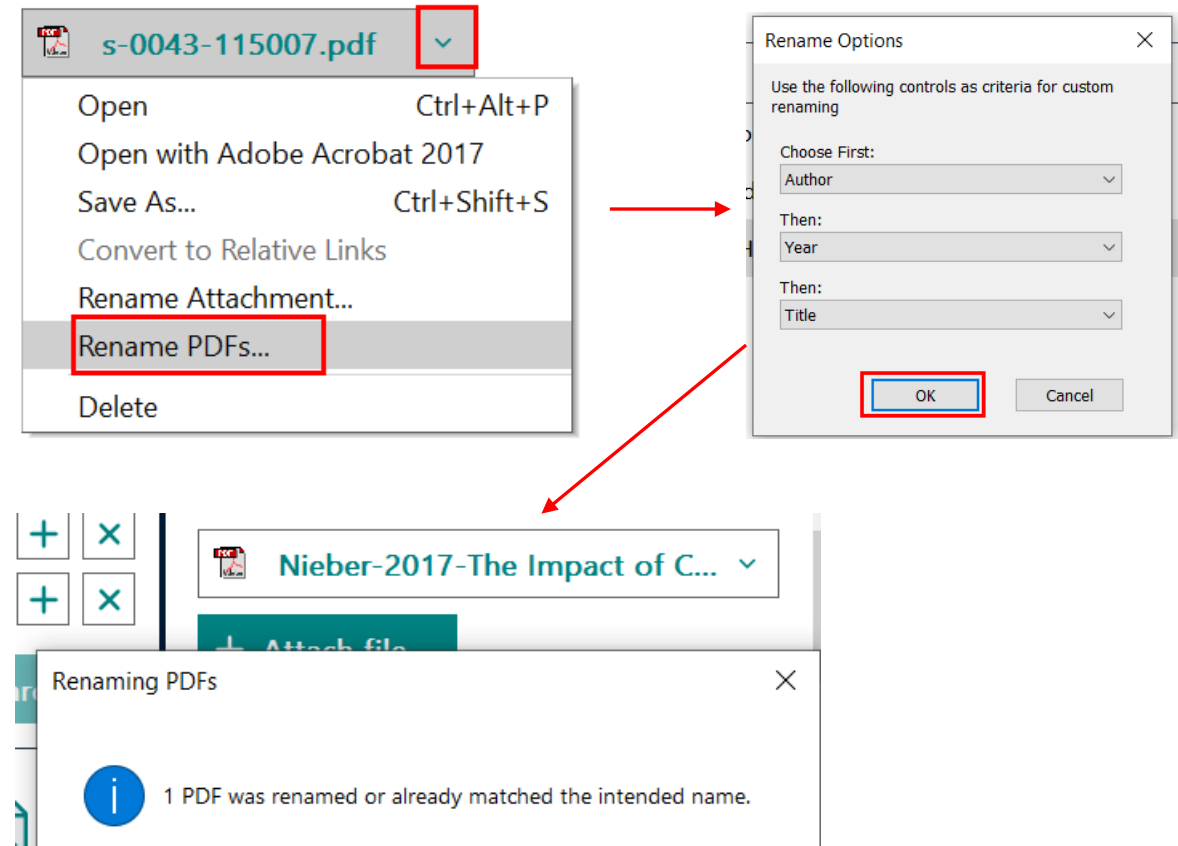



## Easy import of references from PubMed

**PubMed.gov** coffee addiction  
Advanced Create alert Create RSS Clipboard (5)

Save Email **Send to**

MY NCBI FILTERS 191 results

RESULTS BY YEAR

1974 2021

TEXT AVAILABILITY

Clipboard  
My Bibliography  
Collections  
**Citation manager**

1 Apr;51(4):363-73. doi: 10.1080/...

Many research investigations, epidemiological studies, and revealed its inverse correlation with that of diabetes mellitus Alzheimer's disease. ...Caffeine also affects adenosine rec ...

**Caffeine addiction: Need for awareness and r**  
Jain S, Srivastava AS, Verma RP, Maggu G.

**Create a file for external citation management software**

Selection: **Selection (3)**

**Create file** Cancel

Öffnen von pubmed-coffeeaddi-set.nbib

Sie möchten folgende Datei öffnen:

**pubmed-coffeeaddi-set.nbib**  
Vom Typ: NBIB Formatted File (PubMed) (4.3 KB)  
Von: https://pubmed.ncbi.nlm.nih.gov

**Wie soll Firefox mit dieser Datei verfahren?**

☒ **Öffnen mit** ResearchSoft Direct Export Helper (Standard)

☐ Datei speichern

☐ Für Dateien dieses Typs immer diese Aktion ausführen

**OK** Abbrechen

Simple search Search options Search

**Imported References 3**

Recently Added 12  
Unfiled 12  
Trash 0

▼ MY GROUPS  
▼ My Groups  
▼ FIND FULL TEXT  
▼ GROUPS SHARED BY ...

**Imported References**  
3 References

	Year	Title	Author
	2011	Coffee and its consumption: benefits an...	Butt, M. S.; Sultan, M. T.
	2011	Is fast food addictive?	Garber, A. K.; Lustig, R. H.
	2019	Caffeine addiction: Need for awareness ...	Jain, S.; Srivastava, A. S.; Verma, R. P.; Maggu, G.



# Automatic Search for PDFs

Use VPN-Connection!

Imported References  
4 References

Search the Web for full text documents for the selected references

	Year	Title	Author
	2017	Caffeine and cardiovascular health	Turnbull, D.; Rodricks, J. V.; Mariano, G. F.; Chowdhury, F.
	2013	Effects of habitual coffee consumption ...	O'Keefe, J. H.; Bhatti, S. K.; Patil, H. R.; DiNicolantonio, J. J.; Lucan, S. C.;
	2012	Habitual coffee consumption and risk of...	Mostofsky, E.; Rice, M. S.; Levitan, E. B.; Mittleman, M. A.
	2015	Genome-wide meta-analysis identifies si...	Cornelis, M. C.; Byrne, E. M.; Esko, T.; Nalls, M. A.; Ganna, A.; Paynter, N.

Regul Toxicol Pharmacol 2017 Vol. 89 Pages 165-185

Accession Number: 28756014 DOI: 10.1016/j.yrtph.2017.07.025

This report evaluates the scientific literature on caffeine with respect to potential cardiovascular outcomes, specifically relative risks of total cardiovascular disease (CVD), coronary heart disease (CHD) and acute

Imported References  
4 References

Found PDF 2

Not found 2

	Year	Title	Author
	2015	Genome-wide meta-analysis identifies si...	Cornelis, M. C.; Byrne, E. M.; Esko, T.; Nalls, M. A.; Ganna, A.; Paynter, N.
	2012	Habitual coffee consumption and risk of...	Mostofsky, E.; Rice, M. S.; Levitan, E. B.; Mittleman, M. A.
	2017	Caffeine and cardiovascular health	Turnbull, D.; Rodricks, J. V.; Mariano, G. F.; Chowdhury, F.
	2013	Effects of habitual coffee consumption ...	O'Keefe, J. H.; Bhatti, S. K.; Patil, H. R.; DiNicolantonio, J. J.; Lucan, S. C.;



# Insert Citations in Word

EndNote 20 Find & Insert My References

1. Insert Citation

2. Citations

3. Find

4. Gene-coffee interactions and health

5. Insert

1. Fredholm BB, Bättig K, Holmén J, Nehlig A, Zvartau EE. Actions of caffeine in the brain with special reference to factors that contribute to its widespread use. Pharmacol Rev. 1999;51(1):83-133.

EndNote 20 Find & Insert My References

1. Insert Citation

2. Citations

3. Find

4. Gene-coffee interactions and health

5. Insert

1. Fredholm BB, Bättig K, Holmén J, Nehlig A, Zvartau EE. Actions of caffeine in the brain with special reference to factors that contribute to its widespread use. Pharmacol Rev. 1999;51(1):83-133.

2. Cornelis MC. Gene-coffee interactions and health. Current Nutrition Reports. 2014;3(3):178-95.



# Consistent naming of journal names (abbreviation or full name) 1

Style: **New England J Medicine**

Introduction

Coffee is among the most widely consumed beverages in the world.<sup>1</sup> North American coffee drinkers typically consume ~ 2 cups per day while the norm is at least 4 cups in many European countries <sup>1</sup>. In prospective cohort studies, coffee consumption is consistently associated with lower risk of Parkinson's disease, liver disease and type 2 diabetes.<sup>2</sup> However, the effects of coffee on cancer development, cardiovascular and birth outcomes and other health conditions remain controversial <sup>2</sup>.

References

1. O'Keefe JH, Bhatti SK, Patil HR, DiNicolantonio JJ, Lucan SC, Lavie CJ. Effects of habitual coffee consumption on cardiometabolic disease, cardiovascular health, and all-cause mortality. **J Am Coll Cardiol** 2013;62(12):1043-1051. (In eng). DOI: 10.1016/j.jacc.2013.06.035.
2. Turnbull D, Rodricks JV, Mariano GF, Chowdhury F. Caffeine and cardiovascular health. **Regul Toxicol Pharmacol** 2017;89:165-185. (In eng). DOI: 10.1016/j.yrtph.2017.07.025.

Style: **APA 6th**

Introduction

Coffee is among the most widely consumed beverages in the world.<sup>1</sup> North American coffee drinkers typically consume ~ 2 cups per day while the norm is at least 4 cups in many European countries (O'Keefe et al., 2013). In prospective cohort studies, coffee consumption is consistently associated with lower risk of Parkinson's disease, liver disease and type 2 diabetes.<sup>2</sup> However, the effects of coffee on cancer development, cardiovascular and birth outcomes and other health conditions remain controversial (Turnbull, Rodricks, Mariano, & Chowdhury, 2017). |

References

O'Keefe, J. H., Bhatti, S. K., Patil, H. R., DiNicolantonio, J. J., Lucan, S. C., & Lavie, C. J. (2013). Effects of habitual coffee consumption on cardiometabolic disease, cardiovascular health, and all-cause mortality. **Journal of the American College of Cardiology**, 62(12), 1043-1051. doi:10.1016/j.jacc.2013.06.035

Turnbull, D., Rodricks, J. V., Mariano, G. F., & Chowdhury, F. (2017). Caffeine and cardiovascular health. **Regulatory Toxicology and Pharmacology**, 89, 165-185. doi:10.1016/j.yrtph.2017.07.025

independent of full or abbreviated journal name in the record

Journal	Author
Journal of the American College of Cardiology	O'Keefe, J. H.; Bhatti, S. K.; Patil, H. R.; DiNicolantonio, J. J.; Lucan, S. C.; Lavie, C. J.
Regul Toxicol Pharmacol	Turnbull, D.; Rodricks, J. V.; Mariano, G. F.; Chowdhury, F.





## Consistent naming of journal names (abbreviation or full name) 2

requires journals term list

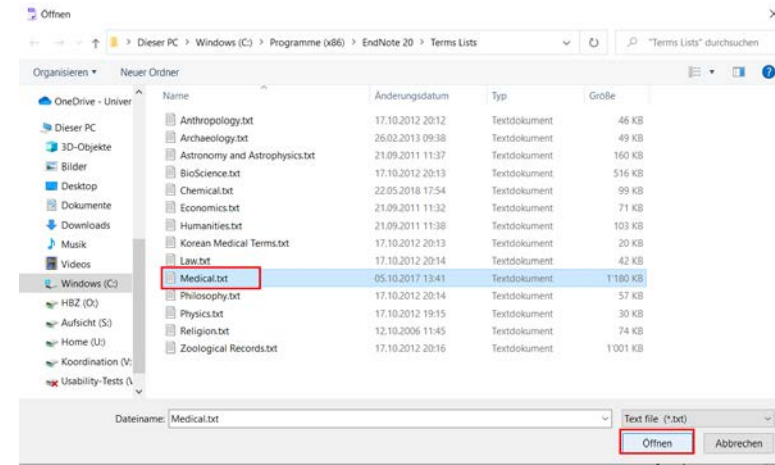
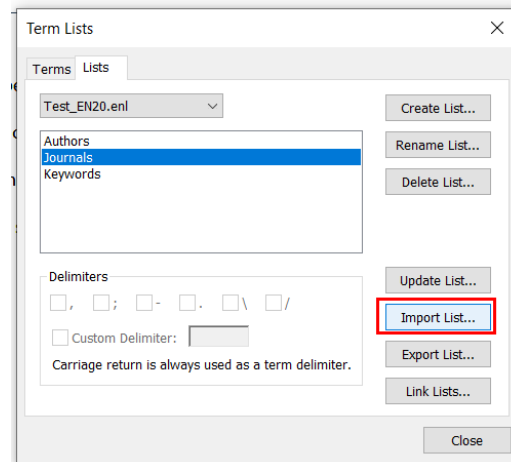
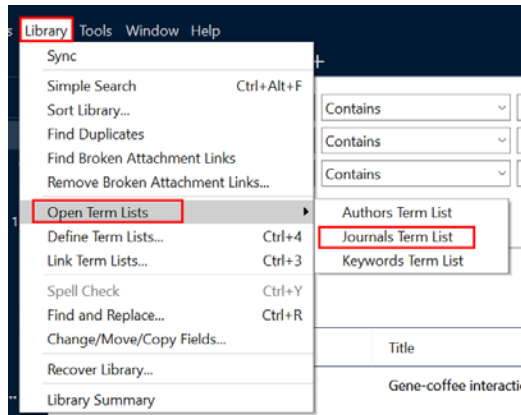

and setting in the output style

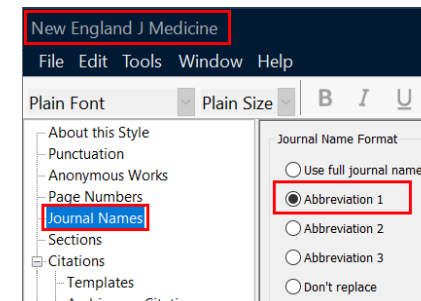
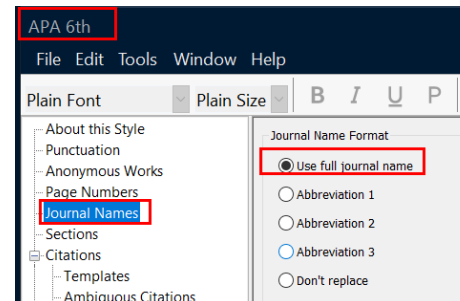



## New Features

- New modern interface
- Improved screening and reading experience
- Improved search options
- Enhanced duplicate detection
- Improved navigation between projects and libraries



## New modern Interface

Edit References Groups

- Undo
- Cut
- Copy
- Paste
- Paste With Text Styles
- Select All
- Change Case
- Font
- Size
- Style
- Preferences...

References Groups Library Tools

- New Reference
- Edit Reference
- Copy References To
- Copy Formatted Reference
- E-mail Reference
- Move References to Trash
- File Attachments
- Find Full Text
- Find Reference Updates
- URL
- Figure
- Web of Science
- Reference Summary

Library Tools Window Help

- Sync
- Simple Search Ctrl+A
- Sort Library...
- Find Duplicates
- Find Broken Attachment Links
- Remove Broken Attachment Links...
- Open Term Lists
- Define Term Lists...
- Link Term Lists...
- Spell Check
- Find and Replace...
- Change/Move/Copy Fields...
- Recover Library...
- Library Summary

Tools Window Help

- Install EndNote Click Browser Extension
- Output Styles
- Import Filters
- Connection Files
- Cite While You Write [CWYW]
- Format Paper
- Subject Bibliography...
- Show Connection Status
- Online Search...



File Edit References Groups **Library** Tools Window Help

All References +

Author	Contains		+	x
And Year	Contains		+	x
And Title	Contains		+	x

Simple search Search options Search

All References  
3 References

Command location in older EN versions:

Edit tab  
References tab  
Tools tab

Gokcen, 2019 #9 **Summary** Edit PDF X

Gokcen-2019-Coffee consumption and diseases...

+ Attach file

Coffee consumption and disease correlations

B. B. Gokcen and N. Sanlier

Crit Rev Food Sci Nutr 2019 Vol. 59 Issue 2 Pages 336-348

Accession Number: 28853910 DOI: 10.1080/10408398.2017.1369391

<https://www.ncbi.nlm.nih.gov/pubmed/28853910>

Kidney Stor

Coffee is one of the most widely consumed beverages in the world. It has primarily consumed due to its stimulant effect and unique taste since the ancient times. Afterwards, its consumption has been historically associated with a lower risk of some diseases such as type 2 diabetes mellitus, obesity, cardiovascular disease and some type of cancer and thus it has also consumed due to health benefits. It contains many bioactive compounds such as caffeine, chlorogenic acids and diterpenoid alcohols which have so far been associated with many potential health benefits. For example, caffeine reduces risk of developing neurodegenerative disease and chlorogenic acids (CGA) and diterpene alcohols have many health benefits



## Simple search and record search

All References

+

coffee

Clear search

Advanced search

Searching All References

7 References

Year	Title
2015	Genome-wide meta-analysis identifies six novel loci associated with habitual coffee consumption
2019	Coffee consumption and disease correlations
2012	Habitual coffee consumption and risk of heart failure: a dose-response meta-analysis
2017	The Impact of Coffee on Health
2013	Effects of habitual coffee consumption on cardiometabolic disease, cardiovascular health, and all-cause mortality
2017	Caffeine and cardiovascular health
2021	Coffee and Caffeine Consumption and Risk of Kidney Stones: A Mendelian Randomization Study

..., 2017... Summary Edit PDF X

B I U X<sup>1</sup> X<sub>1</sub> Save

coffee

Label

Keywords

Caffeine/adverse effects/  
\*pharmacology  
Cardiovascular  
Diseases/\*chemically induced  
Cardiovascular  
System/\*drug effects  
Central Nervous  
System  
Stimulants/adverse effects/  
\*pharmacology  
Coffee  
Hemodynamics/drug effects/\*physiology  
Humans  
Caffeine  
Cardiovascular disease

Abstract

This report evaluates the scientific literature on caffeine with respect to potential cardiovascular outcomes, specifically



## Enhanced Duplicate Detection

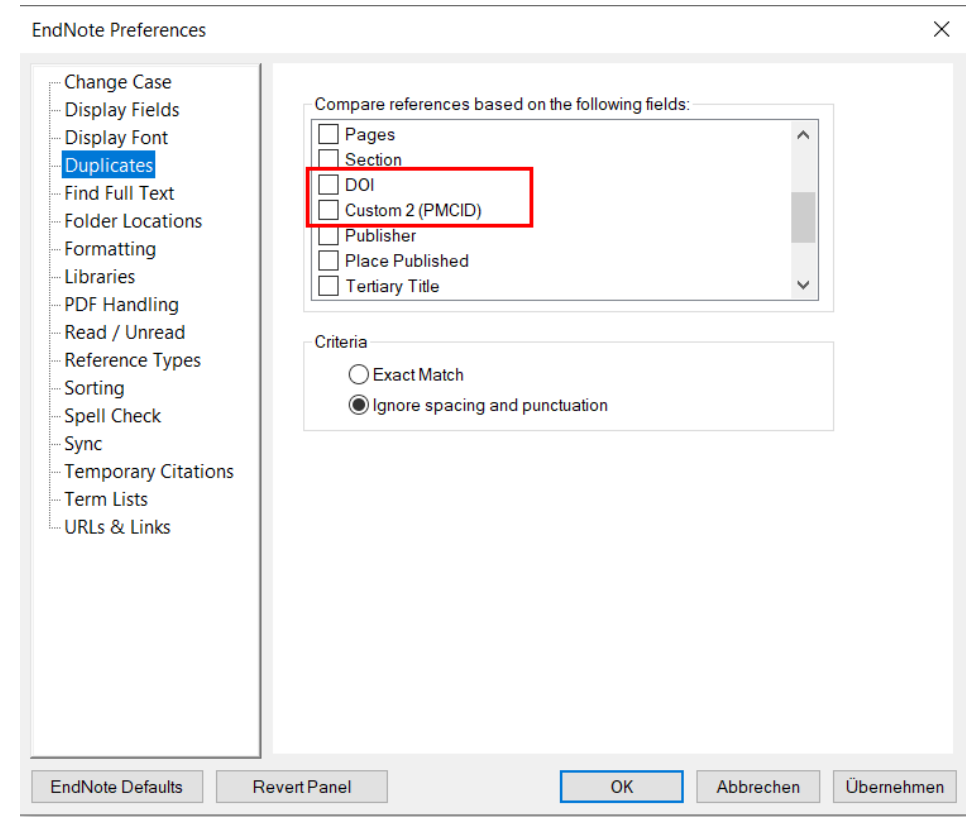
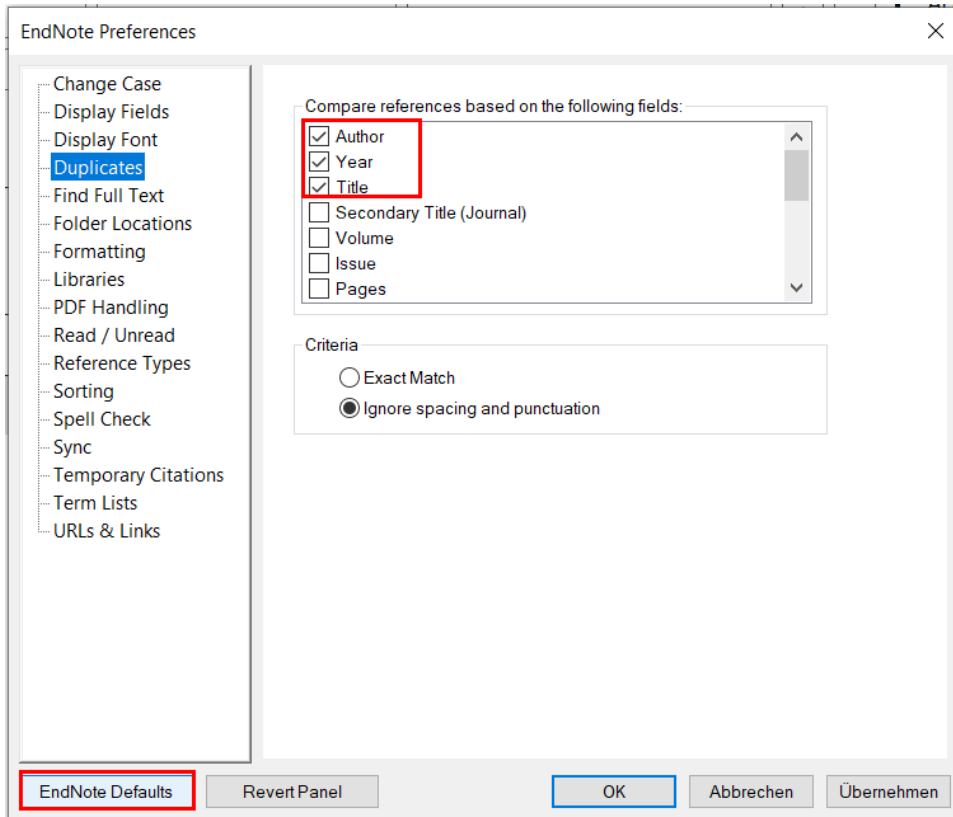



## Tipps for Duplicate Detection

Conference reports often share the same DOI (one DOI for the conference volume)

2017	Skin autofluorescence predicts 4-years risk of incident type 2 ...	Van Waateringe, R. P.; Fokkens, B. T.; Slagter, S. N.;...	S100-S101	Diabetologia	10.1007/s00125-017-4350-z
2017	A2 adenosine receptors mediate chronic caffeine effects on in...	Sacramento, J. F.; Ribeiro, M. J.; Rodrigues, T.; Mat...	S219-S220	Diabetologia	10.1007/s00125-017-4350-z
2017	Caffeine consumption and mortality in diabetes: An analysis ...	Neves, J. S.; Leitão, L.; Magriço, R.; BigotteVieira, M...	S389-S390	Diabetologia	10.1007/s00125-017-4350-z

➤ combine DOI with Pages!



## Tipps for Duplicate Detection

DOI from different database providers come in different formats:

Database Provider	Year	Title	Author	Pages	Journal	DOI
Ovid Technologies	2015	[Inequalities in mortality by cardiovasc...	Cardona, D.; Cerezo Mdel, P.; Parra, H.; ...	379-7...	Biomedica	https://dx.doi.org/10.7705/biomedica.v35i3.2588
NLM	2015	[Inequalities in mortality by cardiovasc...	Cardona, D.; Cerezo Mdel, P.; Parra, H.; ...	379-7...	Biomedica	10.7705/biomedica.v35i3.2588
EBSCOhost	2015	[Inequalities in mortality by cardiovasc...	Cardona, Dora; Cerezo, María Del Pilar; ...	379-7...	Biomedica : re...	10.7705/biomedica.v35i3.2588

### ➤ use Find and Replace

Database Provider	Year	Title
Ovid Technologies	2015	[Inequalitie
NLM	2015	[Inequalitie
EBSCOhost	2015	[Inequalitie

Library Tools Window Help

- Sync
- Simple Search Ctrl+Alt+F
- Sort Library...
- Find Duplicates
- Find Broken Attachment Links
- Remove Broken Attachment Links...
- Open Term Lists
- Define Term Lists... Ctrl+4
- Link Term Lists... Ctrl+3
- Spell Check Ctrl+Y
- Find and Replace... Ctrl+R
- Change/Move/Copy Fields...

Find and Replace

In: DOI

Find: https://dx.doi.org/

☐ Match Case ☒ Match Words

Replace with:

☒ Retain Capitalization

Change Cancel

Journal	DOI
medica	10.7705/biomedica.v35i3.2588
medica	10.7705/biomedica.v35i3.2588
medica : re...	10.7705/biomedica.v35i3.2588



## Navigation improvements for time-saving workflows

open multiple groups in different tabs

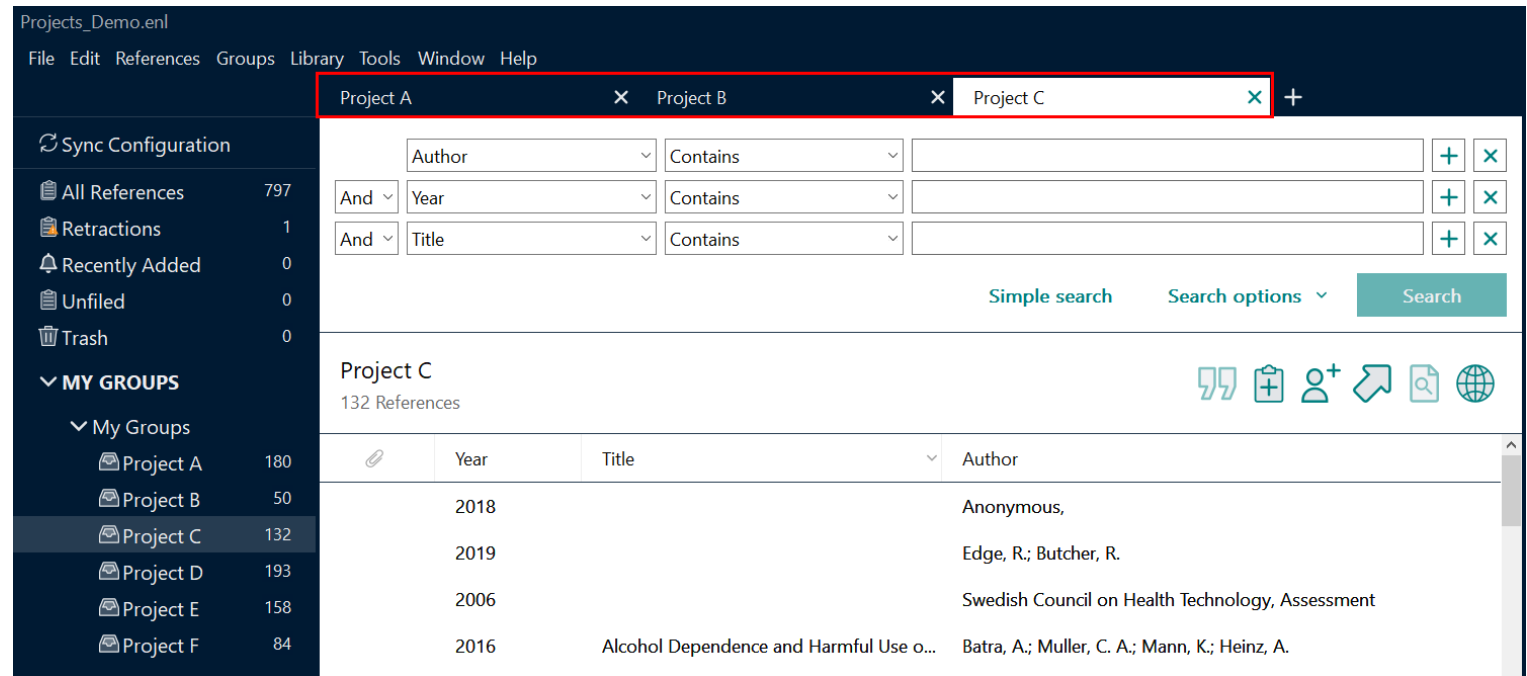
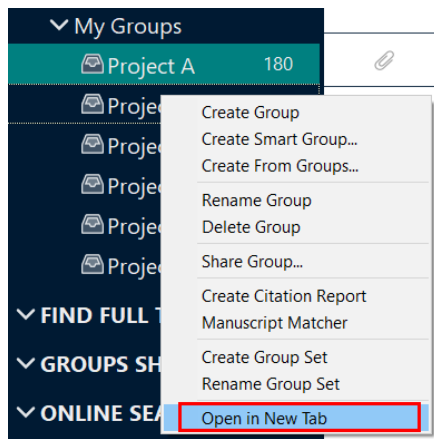

easy library switching: multiple libraries are opened in different windows







## EndNote (20): pros and cons

- 👍 Easier Screening with summary tab
- 👍 Easy switching between projects and libraries
- 👍 Improved adaptable deduplication
- 👍 Advanced and simple search functions with highlighting
- 👍 > 7000 of preset output styles
- 👍 Individual output styles
- 👍 Synchronisation through EndNote online with unlimited cloud space (2 years free)

- 👎 No backward compatibility (prior to ENX9.3) ⇒ use either the sync-function or EN-export /-import for older versions
- 👎 Training / adaptation to new toolbar required
- 👎 Incomprehensible naming of attachment folders

Demo.Data > PDF > 2958972857			↕	↻
			^	
Name				
ndNote		Yuan-2021-Coffee and Caffeine Consum...		
Demo.Data > PDF			↕	↻
			^	
Name			Änderungsda	
EndNote	2958972857	26.11.2021 12		
	3516874045	26.11.2021 12		
sität Zürich UZ	3572125393	26.11.2021 12		